

ACCESS CONTROL

USER MANUAL

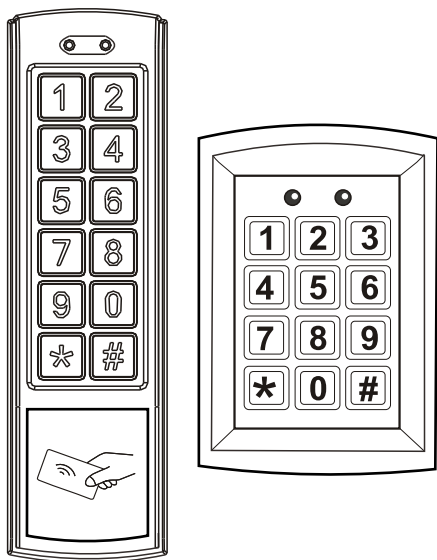

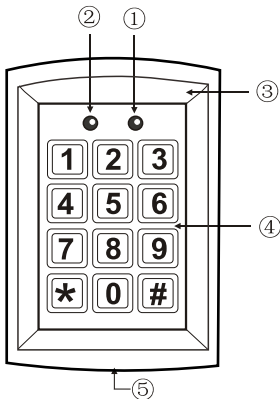

No.	Description
①	Mode indicator
②	Door indicator
③	Antenna
④	Matrix keypad
⑤	Case screw

Working Condition:

Temperature: -30℃~70℃

RH: < 95%

Current and voltage requirements:

DC input: 12~24 VAC or VDC

Standby current: < 30mA

Working current: < 160mA

Application card mode:

EM ID card

Effective distance: 5cm

Capacity: 1010pcs

Specifications / Features

1. Epoxy sealed
2. Vandal resistant
3. Die-cast aluminum
4. Frequency: EM125KHz
5. 2-6 digits pins by programme
6. 12 digits backlight keypad
7. Operation Voltage:12~24 VAC or VDC
8. 2 relays output NO/COM/NC and speaker output
9. Strike time:0—99 seconds
10. Zone1: up to 1000 codes or cards, or combined
Zone2: up to10 codes or cards, or combined
11. 2 LED indicators
12. Operation temperature: -30℃~70℃
13. Installation: Surface mounted
14. Cable length: 1 meter(14-wire for stand-alone,16-wire for network)
15. Waterproof, Dustproof: IP66
16. Colour: Silver
17. Dimension: 76×120×22(mm)

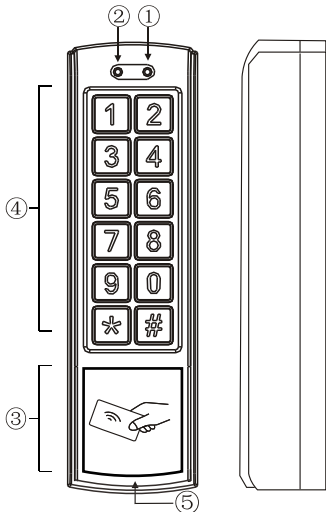

No.	Description
①	Mode indicator
②	Door indicator
③	Antenna
④	Matrix keypad
⑤	Case screw

Working Condition:

Temperature: -30°C~70°C

RH: ≤ 95%

Current and voltage requirements:

DC input: 12~24 VAC or VDC

Standby current: ≤ 30mA

Working current: ≤ 160mA

Application card mode:

EM ID card

Effective distance: 5cm

Capacity: 1010pcs

Specifications / Features

- Rain cover (for option).
- Epoxy sealed
- Vandal resistant
- Die-cast Aluminum
- Frequency: EM125KHz
- 2-6 digits pins by programme
- 12 digits backlight keypad
- Operation Voltage: 12~24 VAC or VDC
- 2 relays output NO/COM/NC and Speaker output.
- Strike time: 0~99 seconds
- Capacity: Zone1, 1000 codes or cards, or combined
Zone2, 10 codes or cards, or combined
- 2 LED indicators
- Operation temperature: -30 °C~70 °C
- Installation: Surface mounted
- Cable length: 1 meter(14-wire for stand-alone, 16-wire for network)
- Water-proof, Dust-proof: IP66
- Color : Silver
- Dimension: 44x150x24(mm)

Installation

Before installation, position the location where the controller unit is to be amount, operation according to the following steps:

1. Open the controller by loosening and removing the back case screw at the bottom using the spline tool.
2. Use the provided drilling template accurately locate and drill the required holes, the four drilling holes marked "B".
3. Use the screws provided to mount the back case on the wall, be sure to draw the wiring through the large center hole in back case, and keep it level.
4. Connected accurately the system wiring as per the label enclosed on the rear.
5. Replace the unit back and screw it on by using the spline tool.

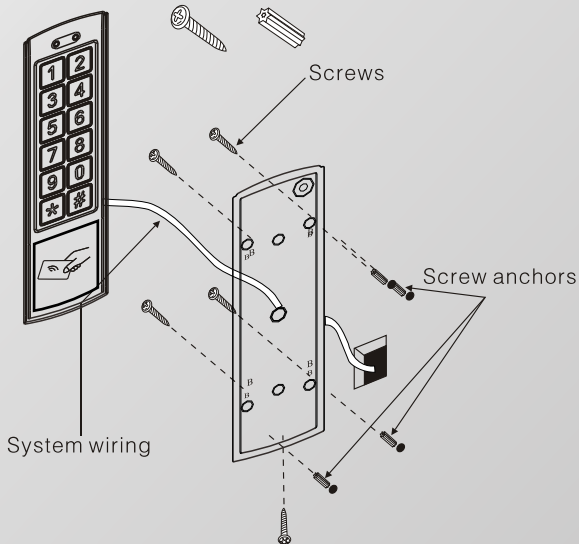

Installation



Notice

Attention items of disassembly

1. Open the cover be careful and following the manual. Not permitted do it in sudden force.
2. Before push out the cover, shift the front cover up for few millimeters (shown in the picture 2), the following as the the picture 3 showed do uplift within the angle range of 20 degrees. Then, take the front cover away slightly.



Picture 1

shift the front
cover up



Picture 2



Picture 3

Installation

Before installation, position the location where the controller unit is to be mounted, operation according to the following steps:

1. Open the controller by loosening and removing the back case screw at the bottom using the spline tool.
2. Use the provided drilling template accurately locate and drill the required holes, the four drilling holes marked "B".
3. Use the screws provided to mount the back case on the wall, be sure to draw the wiring through the large centre hole in back case, and keep it level.
4. Connected accurately the system wiring as per the label enclosed on the rear.
5. Replace the unit back and screw it on by using the spline tool.

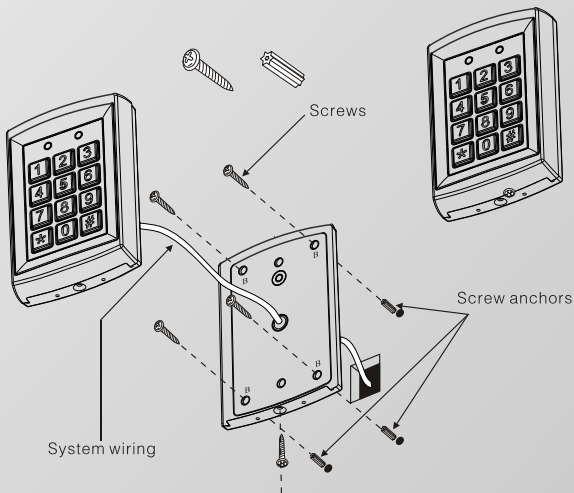
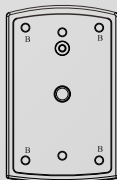

Operation

1. 2 zones relays can be programmed for opening the lock, up to 1000 user cards and correlative codes can be stored into ZONE 1, 10 user cards or codes can be stored into ZONE 2. In addition the ZONE 1 can be programmed for 3 modes to open the lock: only the card access, both the code or card access, card+code combined access. The Zone 2 could connect to a door bell.
2. Default code is 1234.
3. Input the default code twice(1234+1234) to enter the setting mode, mode indicator will turn yellow.

Access mode setting

Enter the setting mode:

Press the button **[*]** and **[0]**, the mode indicator will flash yellow, follow the button **[0]** twice, the mode indicator will turn yellow, a long beep will be heard. It indicates that only the card access is available.

Press the button **[*]** and **[0]**, the mode indicator will flash yellow, follow the button **[0]** and **[1]**, the mode indicator will turn yellow, a long beep will be heard, it indicates that both the card and code access are available.

Press the button **[*]** and **[0]**, the mode indicator will flash yellow, follow the button **[0]** and **[2]**, the mode indicator will turn yellow and a long beep will be heard, it indicates that card and code access combined is available.

Press the button **[#]** to quit the setting mode.



Setting the length of the master Code

Enter the setting mode:

Press **[*]** and **[9]** (Yellow indicator start to flash), then press **[0]** (B sound will be heard), then input number of code digits X (X=2,3,4,5,6, 2 means 2 digits, 3 means 3 digits, the rest may be deduced by analogy), when the Bi sound heard, indicates the length of the master code has been successfully changed. If Bi Bi Bi 3 tones are heard, means the code length are same as the existed length.

Press button **[#]** to exist the setting mode.

NOTE: When the length of the master code is changed, all existing cards / tokens and user codes will be deleted.

Add the user card and code(ZONE 1).

Enter the setting mode(ZONE1):

Press one number from 000 to 999 (mode indicator will flash yellow, it indicates there is already the data existed if turn red. Clean the data existed at this address by pressing the button **[*]** twice, the flashing green LED indicates that the user cards and codes are allowed to add), swipe the user card and input the 4-digit code xxxx, a long beep will be heard, it indicates that adding success. Repeat the steps as above to add others.

Press the button **[#]** to quit the setting mode.

Add the user card and code(ZONE 2).

Enter the setting mode(ZONE 2):

Press the button **[*]** and **[4]** (mode indicator will flash yellow), press one number from 00 to 09 (mode indicator will flash yellow, it indicates there is already the data existed if turn red. Clean the data existed at this address by pressing the button **[*]** twice, the flashing green LED indicates that the user cards and codes are allowed to add), swipe the user card or input the 4-digit code xxxx, a long beep will be heard, it indicates that adding success. Repeat steps as above to add others.

Press the button **[#]** to quit the setting mode.

Set the unlocking time for ZONE 1

Enter the setting mode.

Press the button **[*]** and **[1]**, the mode indicator will flash yellow, follow the number from 00 to 99, the mode indicator will turn yellow in the mean time a long beep will be heard, it indicates a success of delay time setting. 00-99 means the delay time. I.e. 05 means the unlocking time is 5s delayed. If setting lock-time as 00 means: swipe card or input password once open the door, swipe card or input password again close the door.

Press the button **[#]** to quit the setting mode.

Set the unlocking time for ZONE 2

Enter the setting mode:

Press the button **[*]** and **[5]**, the mode indicator will flash yellow, follow the number from 00 to 99, the mode indicator will turn yellow in the mean time a long beep will be heard, it indicates a success of delay time setting. 00-99 means the delay time i.e. 05 means the unlocking time is 5s delayed. If setting lock-time as 00 means: swipe card or input password once open the door, swipe card or input password again close the door.

Press the button **[#]** to quit the setting mode.

Clean all user cards and codes , restores to factory defaults

Enter the setting mode:

Press the button **[*]** and **[8]** (mode indicator will flash yellow), follow the button **[8]** twice, (a continuous beep will be heard and mode indicator will turn yellow), it indicates all user cards and codes have been cleaned out successfully.

Press the button **[*]** and **[9]** (mode indicator will flash yellow), follow the button **[9]** twice, (a continuous beep will be heard and mode indicator will turn yellow), it indicates it restores to factory defaults.

Press the button **[#]** to quit the setting mode.

If do operation in a wrong way, it will imply as BI.BI. sounds. The device would turn back without actions in 30s automatically accompany with BI.BI. sounds. If in the access mode as card and password entry in, just did one of actions(input password or swipe or swipe the card), it will turn back in 5s automatically accompany with BI.BI. sounds.

Door indicator



- A. When ZONE 1 relay activated, door indicator will turn green.
- B. When ZONE 2 relay activated, door indicator will turn red.

If forgot the password, shut off the power and press **[#]**, then turn on the power After Bi---sounds, the password default back as 1234.

The pickproof alarm

The built-in buzzer will sent a continuous beeping if the photoresistor sensor is directly exposed into the light. The buzzer will off automatically in 60s, the light is no longer detected by enter the admin code.

Modify administrator code

Enter the setting mode:

Press the button **[*]** and **[3]** (mode indicator will flash yellow), and input new 4-digit codes XXXX and repeat it once again.

Press the button **[#]** to quit the setting mode.

Turn on/off the pickproof alarm

Enter the setting mode:

Press the button **[*]** and **[6]** (mode indicator will flash yellow), then following enter the **[0]** and **[1]**, a long beep will be heard whilst the mode indicator will turn yellow, pickproof alarm is turned off.

Press the button **[*]** and **[6]** (mode indicator will flash yellow), then following enter the **[0]** and **[2]**, a long beep will be heard whilst the mode indicator will turn yellow, pickproof alarm is turned on.

Press the button **[#]** to quit the setting mode.

Exit button function

NOTE: Each door can have one exit button.

Add the master card(only useful for zone 1)

Enter the setting mode:

Press the button **[*]** and **[7]**, the mode indicator will flash green, it indicates there is no master card stored, if the indicator turns red, it indicates there is already data existed, press the button **[*]** twice to clean out the data, and then indicator will flash green, swipe the master card, a long beep will be heard, it indicates that adding success.

Press the button **[#]** to quit the setting mode.

Using the master card enter the setting mode

Swipe the master card, the indicator will flash yellow whilst a long beep will be heard, enter the setting mode. Swipe the master card again, the indicator will turn green whilst three times rapid beep will be heard, quit the setting mode.

The access control will be locked for 60s if the mistaken code continuously input or swipe the invalid card for 5 times, both the keypad operating and the card swiping is not available. Detect the door status: when someone opens the door and comes in, the door is closed, the system will automatically detect the door status and lock the door even though the it is still delay period.

NOTE: The user code must be different from the administration code.

The code of ZONE 1 must be different from that of ZONE2.

Add cards in batches(Zone 1)

Enter the setting mode:

Press **[*]** and **[9]** (Yellow indicator start to flash), then press **a[0]** (**[B]** sound can be heard),
Enter 1 location slot 000-999 from which the batch is to start.

Then enter the amount of cards you wish to enter. e.g.050 indicates 50 cards are to be entered.
A short tone will then be heard. This signifies that all the batch cards can now be shown to the keypad one at a time. Each card will be added to the next allocation slot in order from where you started the batch adding.

Press **[#]** button to exit the setting mode.

Add user codes(Zone 1)

Enter the setting mode:

Press **[*]** and **[9]** (Yellow indicator start to flash), then press **a[0]** (**[B]** sound can be heard and),
Then enter the location slot 000-999(each code must be allocated its own user slot).

Then enter the new user code(the length of the user code must be the same as the master code).

Press **[#]** button to exit the setting mode.

NOTE: If the location slot has been set a code, the operation will modify the existed code.

Add user codes(Zone 2)

Enter the setting mode:

Press **[*]** and **[9]** (Yellow indicator start to flash), then press **a[0]** (**[B]** sound can be heard and),
Then enter the location slot 00-09(each code must be allocated its own user slot).

Then enter the new user code(the length of the user code must be the same as the master code).

Press **[#]** button to exit the setting mode.

NOTE: If the location slot has been set a code, the operation will modify the existed code.

Remarks:

If three consecutive keyboard input errors occurred, the keyboard will be locked for 60 seconds .
Any keyboard operation is invalid within 60 seconds.

Wiring Diagram

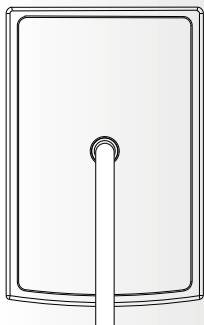

- 1.Red
- 2.Black
- 3.Brown
- 4.Orange
- 5.Yellow
- 6.Green
- 7.White
- 8.Pink
- 9.Aqua
- 10.Blue
- 11.Purple
- 12.Grey
- 13.Brown/White
- 14.Black/White
- 15.Shielding line

1	Power
2	Supply
3	DoorMagnet
4	Exit Button1
5	Exit Button2
6	GND
7	NO 1
8	COM 1
9	NC 1
10	NO 2
11	COM 2
12	NC 2
13	BELL
14	GND
15	Shielding line

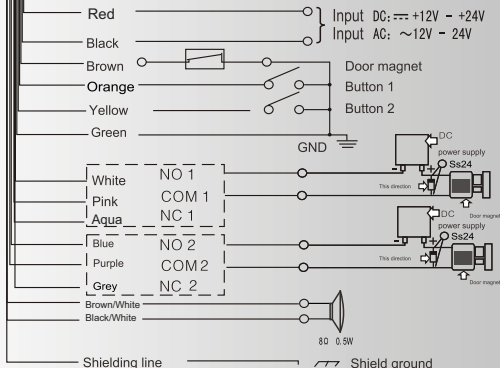
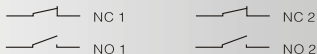

Wiring Diagram

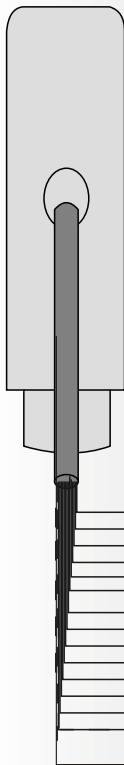

- 1.Red
- 2.Black
- 3.Brown
- 4.Orange
- 5.Yellow
- 6.Green
- 7.White
- 8.Pink
- 9.Aqua
- 10.Blue
- 11.Purple
- 12.Grey
- 13.Brown/White
- 14.Black/White
- 15.Shielding line

1	Power
2	Supply
3	DoorMagnet
4	Exit Button1
5	Exit Button2
6	GND
7	NO 1
8	COM1
9	NC 1
10	NO 2
11	COM2
12	NC 2
13	BELL
14	GND
15	Shielding line



- 1.Red
- 2.Black
- 3.Brown
- 4.Orange
- 5.Yellow
- 6.Green
- 7.White
- 8.Pink
- 9.Aqua
- 10.Blue
- 11.Purple
- 12.Grey
- 13.Brown/White
- 14.Black/White
- 15.Shielding line

