

Technical Support

 **01273 811011**



support@paxton.co.uk

Technical help is available: Monday - Friday from 07:00 - 19:00 (GMT)
Saturday from 09:00 - 13:00 (GMT)

Documentation on all Paxton products can be found on our website - <http://www.paxton.co.uk/>

Layout

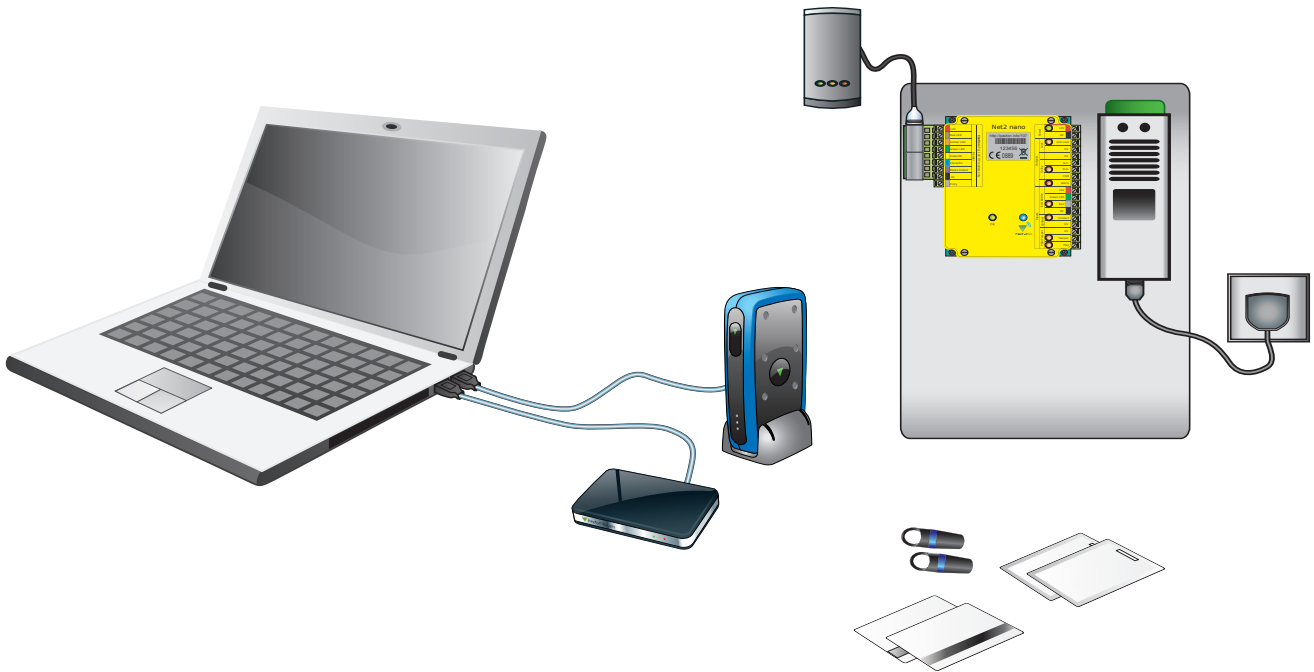

What's in the box?

Figure 8 IEC power lead.		
Net2 demonstration cards and keyfobs		
RJ45 - Reader port connector module		
Documentation		
Part Number	Qty	Description
654-772	1	Net2 nano with 2A PSU in plastic cabinet
353-110	1	PROXIMITY P50 reader
477-268	1	Net2Air USB bridge
514-326	1	Net2 desktop reader USB

Please go to the following link to download your copy of Net2 Lite software. < <http://paxton.info/1438> >

Each unit contains full installation documentation.

Further information is available on our website and from the following on-line application notes:

- AN1095 - Net2 nano - How does it work?* < <http://paxton.info/974> >
- AN1096 - How to plan a Net2 nano installation* < <http://paxton.info/975> >

Technical Support

 01273 811011

 support@paxton.co.uk

Technical help is available: Monday - Friday from 07:00 - 19:00 (GMT)
Saturday from 09:00 - 13:00 (GMT)

Documentation on all Paxton products can be found on our website - <http://www.paxton.co.uk/>

Layout

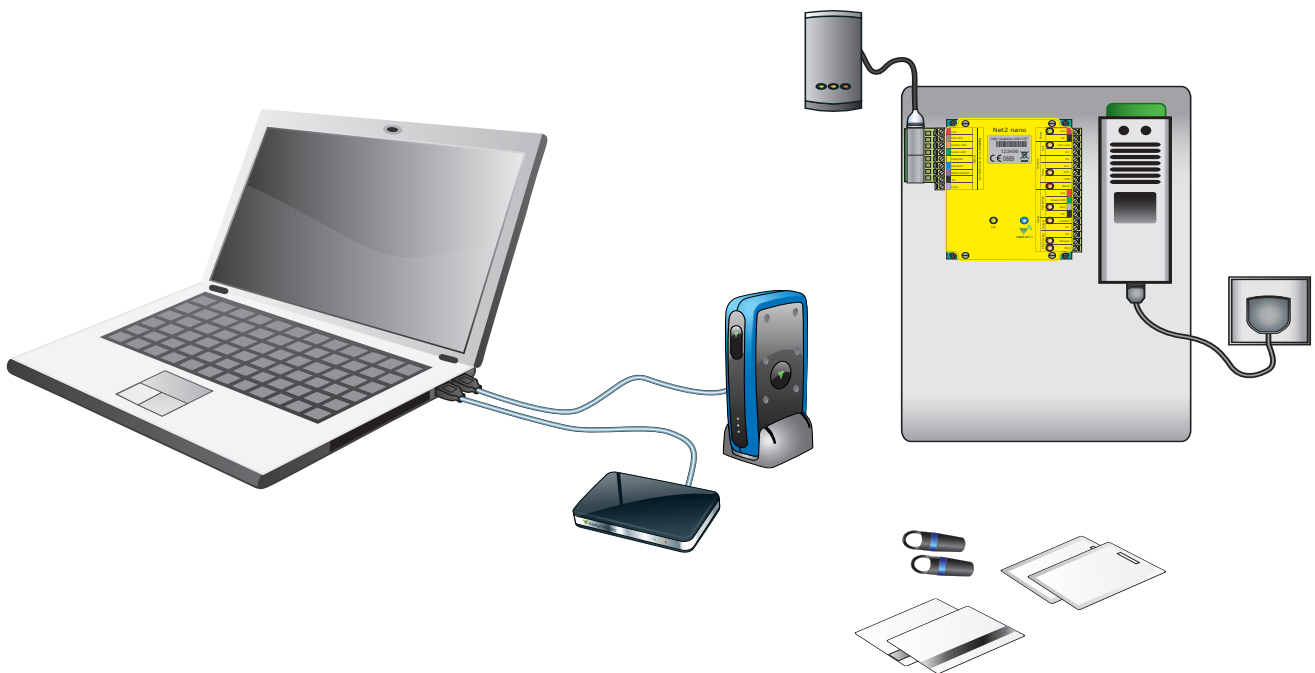

What's in the box?

Figure 8 IEC power lead.		
Net2 demonstration cards and keyfobs		
RJ45 - Reader port connector module		
Documentation		
Part Number	Qty	Description
654-772	1	Net2 nano with 2A PSU in plastic cabinet
353-110	1	PROXIMITY P50 reader
477-268	1	Net2Air USB bridge
514-326	1	Net2 desktop reader USB

Please go to the following link to download your copy of Net2 Lite software. < <http://paxton.info/1438> >

Each unit contains full installation documentation.

Further information is available on our website and from the following on-line application notes:

AN1095 - Net2 nano - How does it work? < <http://paxton.info/974> >
AN1096 - How to plan a Net2 nano installation < <http://paxton.info/975> >