

## DEVICE TECHNICAL DATA

MODEL	AU-A1ZBKWC
AMBIENT TEMPERATURE LIMITS	-25°C to +65°C
PROTOCOL	Zigbee Greenpower
FREQUENCY BAND	2.4GHz
MAX OUTPUT RF POWER	7 dBm/ 5 mW

## TERMINAL BLOCKS TECHNICAL DATA

VOLTAGE	450V
MAX CURRENT	32A
MAX TEMPERATURE	T-Mark 85°C
CONDUCTOR TYPE & SIZE	0.14 - 4mm <sup>2</sup>

- There are no restrictions of use.
- Installation must be carried out in accordance with the latest edition of the Wiring Rules by a qualified electrician.
- Hereby, Aurora Limited declares that the radio equipment type AU-A1ZBKWC is in compliance with Directive 2014/53/EU. The full text of the EU declaration of conformity is available at the following internet address: [www.auroralighting.com/ProductDetail/AU-A1ZBKWC](http://www.auroralighting.com/ProductDetail/AU-A1ZBKWC)

## USING THE APP TO CONNECT THE KINETIC WALL CONTROLLER TO THE HUB

1. Download the AOne App from the App Store.
2. Follow instructions on the AOne App to send the hub into pairing mode and pair your devices (further details below).
3. Put the controller into pairing mode:
  - a) Push and hold the top left button for more than 7 seconds and release,
  - b) Push and immediately release the top left button,
  - c) Push and hold the top left button for more than 7 seconds and release.
4. The controller is now in pairing mode. The Zigbee Hub can be broadcasting on 16 possible channels, and you can cycle through the channels:
  - a) Push and release the top left button once every two seconds to cycle through the broadcast channels,
  - b) Once a device has been discovered on the AOne App, stop pushing the button,
  - c) Push any of the other 3 buttons to store the channel.

The device can now be controlled using the AOne App. You will need to select which devices you want the Kinetic Wall Controller to control via the AOne App.

## STANDARD FUNCTION:

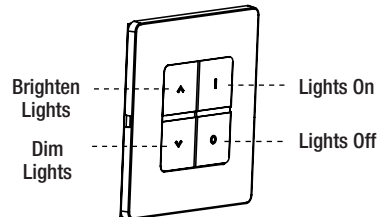

- 1 **Important information:** Pair smart devices to the AOne Hub before installing Kinetic Wall Controller.

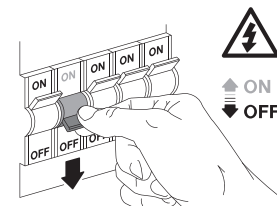

- 2 Minimum depth of backbox must be 16mm

- 3A **Without Earth Cable**  
Terminal blocks included in box to safely connect your live & switched live, providing constant power to the lights.

- 3B **With Earth Cable**  
Terminal blocks included in box to safely connect your live & switched live, providing constant power to the lights. Connect Earth cable to the second Terminal block.

- 4 **Optional Earth Cable**

- 5 **CLICK!**

- 6 **ON**  
**OFF**

- 7 **Download / control through the AOne App**

