

RCONT TI / TFI / TIU / TFIU

User's Manual

Introduction

The system is designed for applications where pedestrian doors installed on garage doors. Is a position detection system of the pedestrian door status, so that if it is open the system prevents the start of the movement of the garage door. Is a wireless system composed by one transmitter and one receiver. The receiver monitors the status of transmitters connected to it.

The system complies with EN ISO 13849-1, category 2, PLc (RCONT TFI / RCONT TFIU).

Technical data

Frequency	869,50 MHz (RCONT TI / RCONT TFI) 868,90MHz (RCONT TIU / RCONT TFIU)
Power supply	3V DC (2 x 1.5V LR6 AA)
Operating standby / consumption	0,1 mA / 12mA
Radiated power	< 1mW
Operating temperature	-20°C - +85°C
Watertightness	IP65 (RCONT TI / RCONT TIU) IP66 (RCONT TFI / RCONT TFIU)
Size	151 x 60 x 23mm (RCONT TI / RCONT TIU) 120 x 65 x 40mm + 65 x 65 x 40mm (RCONT TFI / RCONT TFIU)
Range	50m
Battery life (aprox)	2 años

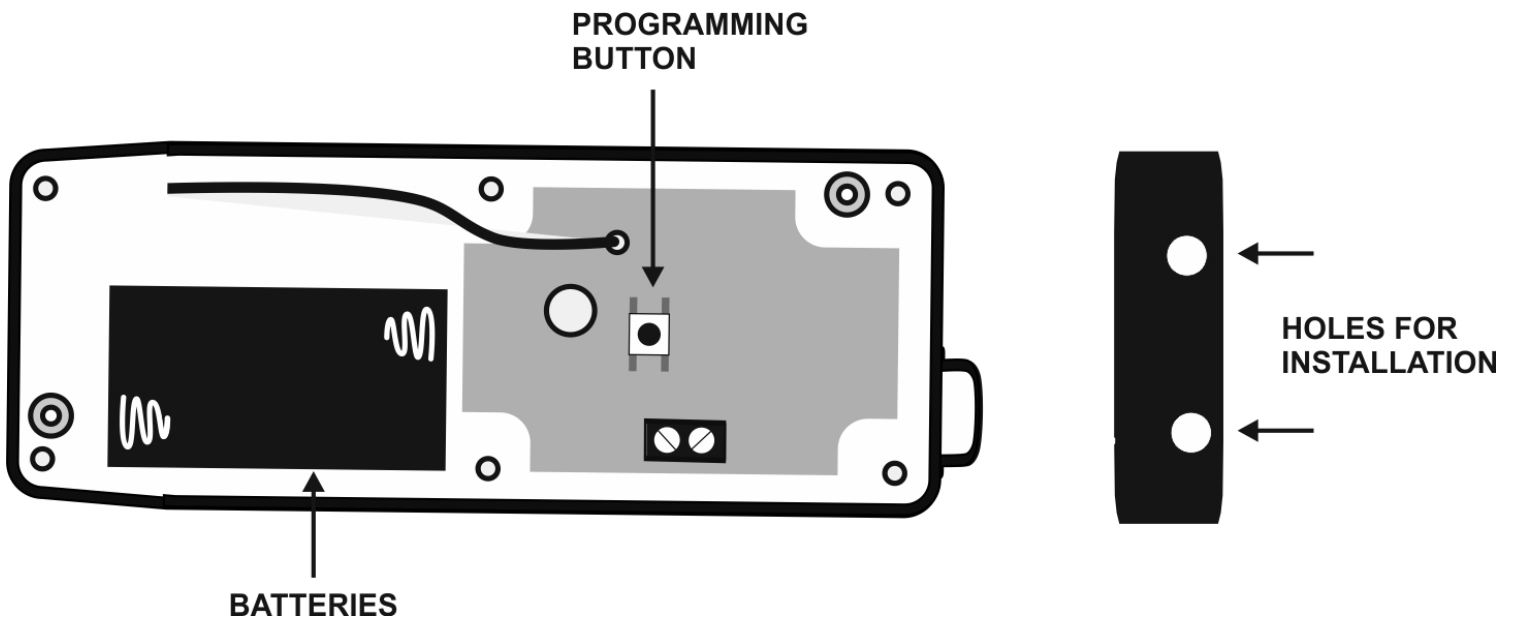

Starting up

Mechanical installation

Install the transmitter following the installation steps and tips below.

Install the two parts of the transmitter, one in front of the other, as shown in figure below. Avoid placing metal surfaces between the receiver and transmitter.

UNSCREW TO OPEN COVER



INSERT BATTERIES



PLACE THE TWO PARTS

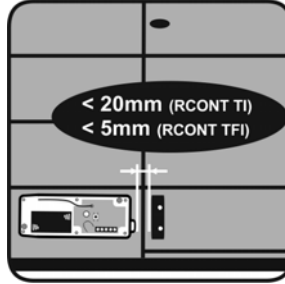

DRILL DOOR



SCREW TO CLOSE COVER

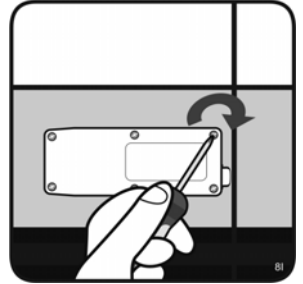

Programming the transmitter on the receiver

While programming the receiver, press the PROG button on the transmitter to be programmed into the receiver. The receiver allows programming 6 transmitters (3 for Relay 1 and 3 for Relay 2).

Each safety edge transmitter must be learnt into the appropriate channel of the safety edge receiver.

Mode	Configuration of transmitter programming in the receiver.	Led R1	Led R2
1	When you open the pedestrian door, relay 1 on the receiver will be activated	ON	OFF
2	When you open the pedestrian door, relay 2 on the receiver will be activated	OFF	ON
3	When you open the pedestrian door, the two relays will be activated at the same time	ON	ON

PRESS RPROG BUTTON

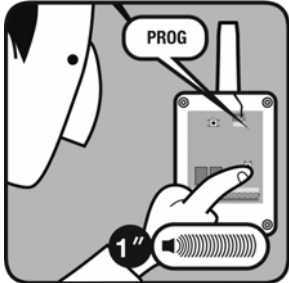

LED TURNS ON

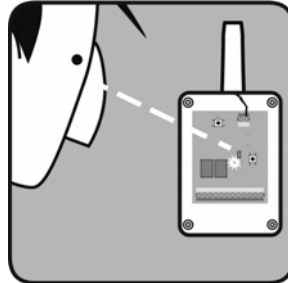

PRESS TRANSMITTER PROG

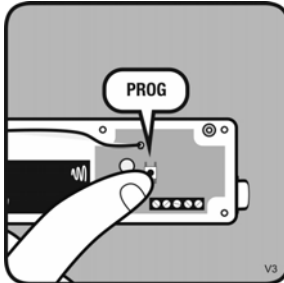

ONE BEEP & PROGRAMMED

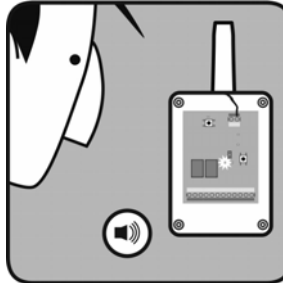

PRESS RPROG BUTTON

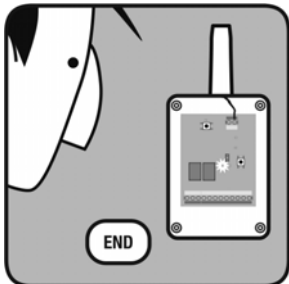

LED TURNS OFF & END PROG

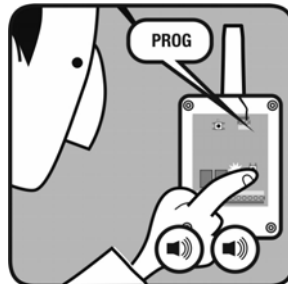

Maintenance

Beeps and leds error indication table

Equipment	Error	Beeps	Leds
RCONTACT R	RCONTACT T low battery	4 beeps each 20 seconds	OFF
RCONTACT R	Communication error between RCONTACT R and RCONTACT T	No pitidos	ON

Replacing the transmitter battery

Remove the box cover. Replace the two used batteries with new ones, taking into account the polarity indicated by the connector.

Check that the new batteries support the same temperature range as those they are replacing.

Use of the system

This equipment is designed for applications where pedestrian doors installed on garage doors. It is not guaranteed for directly activating equipment other than that specified.

The manufacturer reserves the right to change the specification of the equipment without prior warning.

Important annex

Disconnect the power supply whenever you proceed to the installation or repair of the control panel.

In accordance with the European low voltage directive, you are informed of the following requirements:

- For permanently connected equipment, an easily accessible connection device must be incorporated into the cabling.
- This system must only be installed by a qualified person that has experience with automatic doors/gates and knowledge of the relevant EU standards.
- The instructions for use of this equipment must always remain in the possession of the user.
- The frequency of the RContact system does not interfere in any way with the 868 MHz remote control systems.

JCM TECHNOLOGIES, S.A. declares herewith that the product **RCONT TI, RCONT TFI, RCONT TIU, RCONT TFIU** complies with the requirements of the 1999/5/ CEE R&TTE Directive, and complies with the fundamental requirements of the 2006/42/CE Machine Directive, 2004/108/EC Directive on electromagnetic compatibility and 2006/95/EC on low voltage, insofar as the product is used correctly.

EC Declaration of conformity

See web www.jcm-tech.com