

Bat K2

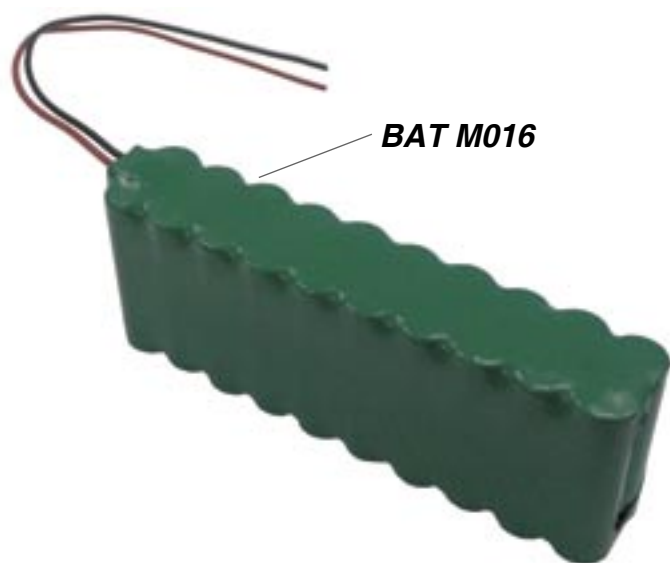

Battery charger card for Star 124, 224 and 224 Box



BAT M016



BAT K2

1 - GENERAL DESCRIPTION

The "BAT K2" card is arranged to charge batteries up to **24Vdc** and max **7Ah**.

"BAT K2" includes only the battery charger card. The batteries can be bought separately (KING-gates code "BAT M016"). The duration of the batteries depends on the Ah of the battery, the absorbing of the motor (or the motors) connected, and the total absorbing of the accessories.

ⓘ The batteries, when connected, are generally flat.

It is necessary to wait about 16 hours for a full charge of the batteries.

2 - INSTALLATION ON "STAR M224" (MODUS operator)

Below it is shown how to install "BAT K2" on a "STAR M 224" ("Modus" operator).

On "Modus" operator, the box where the charger card is inserted is not necessary, since there is a proper compartment on the bracket of the control unit.

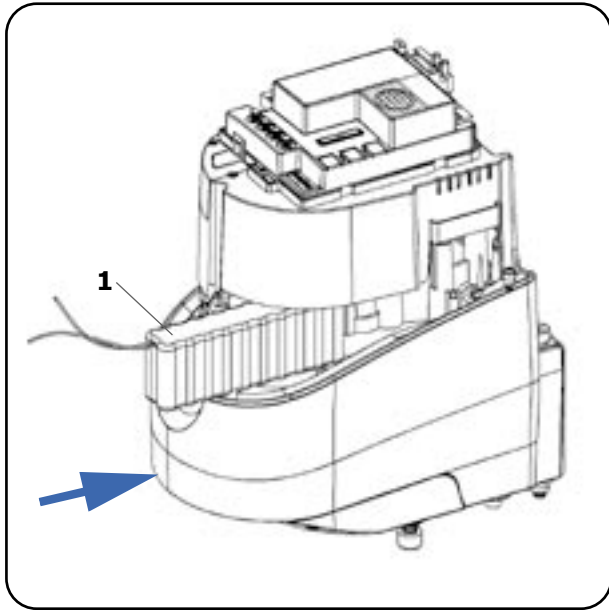

Take off the cover (2) removing the screws (3). Then, take off the card (4) from its box, and insert it on the bracket (the supplied box is not necessary). After having done the connections shown on paragraph 5 or 6 fix the cover again (2).

If the batteries (1) are compatibles with the dimensions, insert them in the proper compartment (the KING-gates batteries "BAT M016" are arranged to be inserted in the operator).

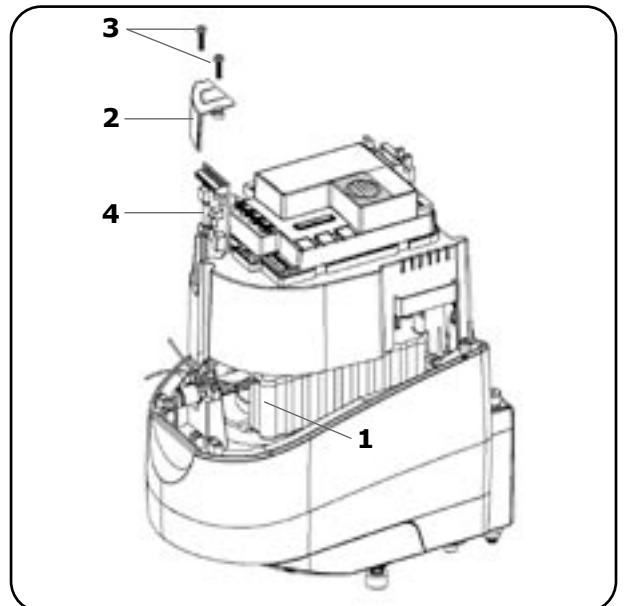

3 - INSTALLATION ON "STAR D124" (DYNAMOS 24-600 / 350 EV OPERTOR)

Below it is shown how to install "BAT K2" on a "Star D124" (operators "Dynamos 24/600" or "Dynamos 24/350 EV").

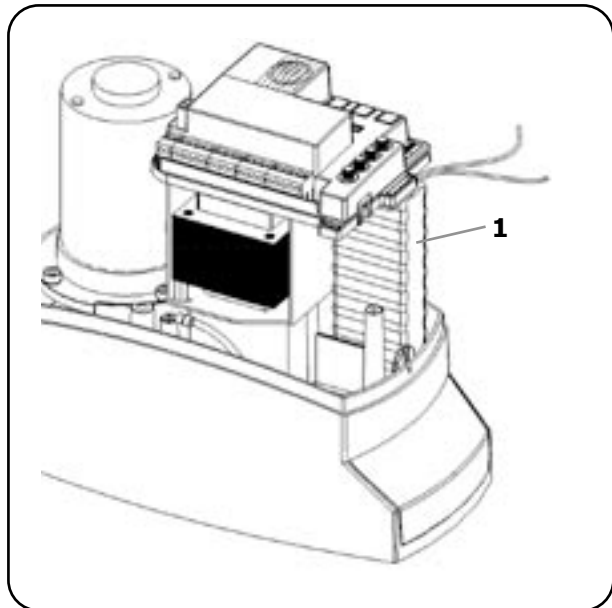

If the batteries (1) are compatibles with the dimensions, insert them in the proper compartment (the KING-gates batteries "BAT M016" are arranged to be inserted in the operator).

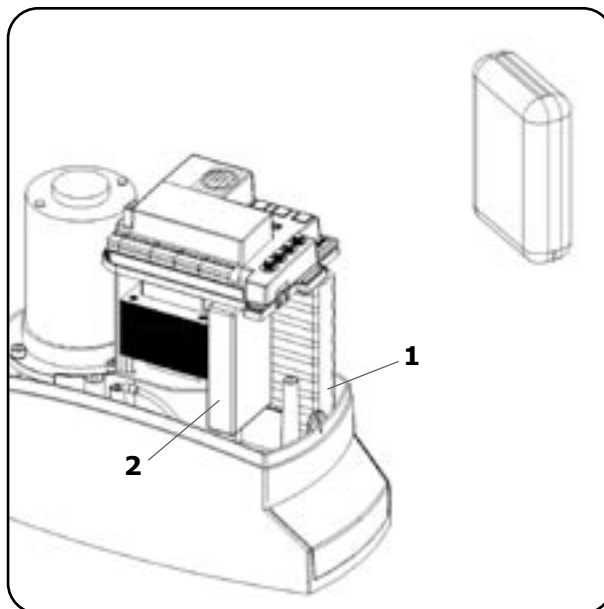

After having done the connections shown on paragraph 4, 5 or 6 inserire la "BAT K2" (2) on the proper compartment.

4 - ELECTRIC CONNECTIONS

The connections must be done without tension, and paying attention to not to touch the poles of the battery.

ⓘ The batteries must be 24Vdc max 7Ah

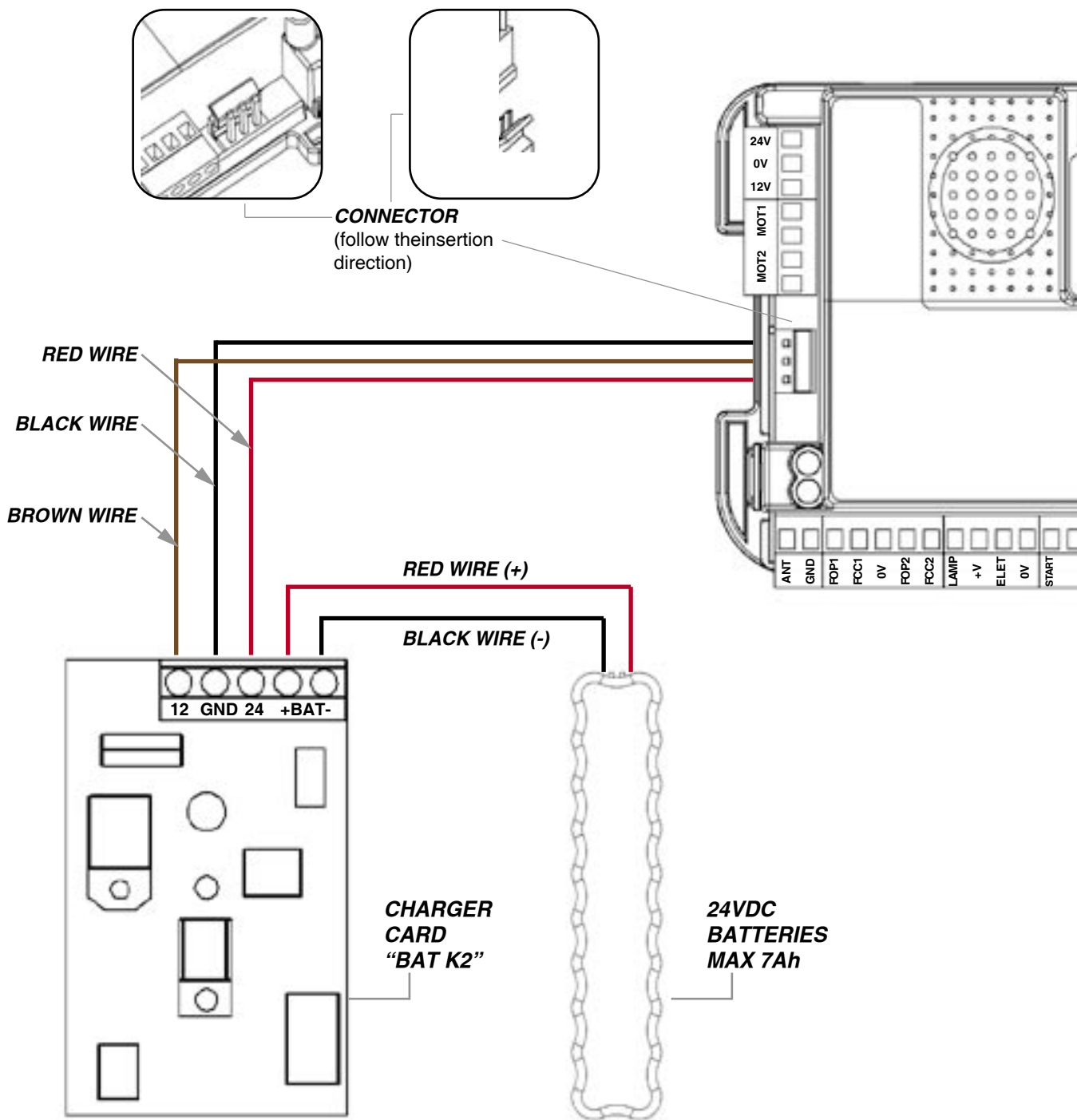

5 - CONNECTION OF AN ELECTRO LOCK WITH "SELC 12"

In presence of an electro lock (manageable only by the control units "Star 224" and "Star M224") connect it as shown below.

ⓘ The batteries must be 24Vdc max 7Ah

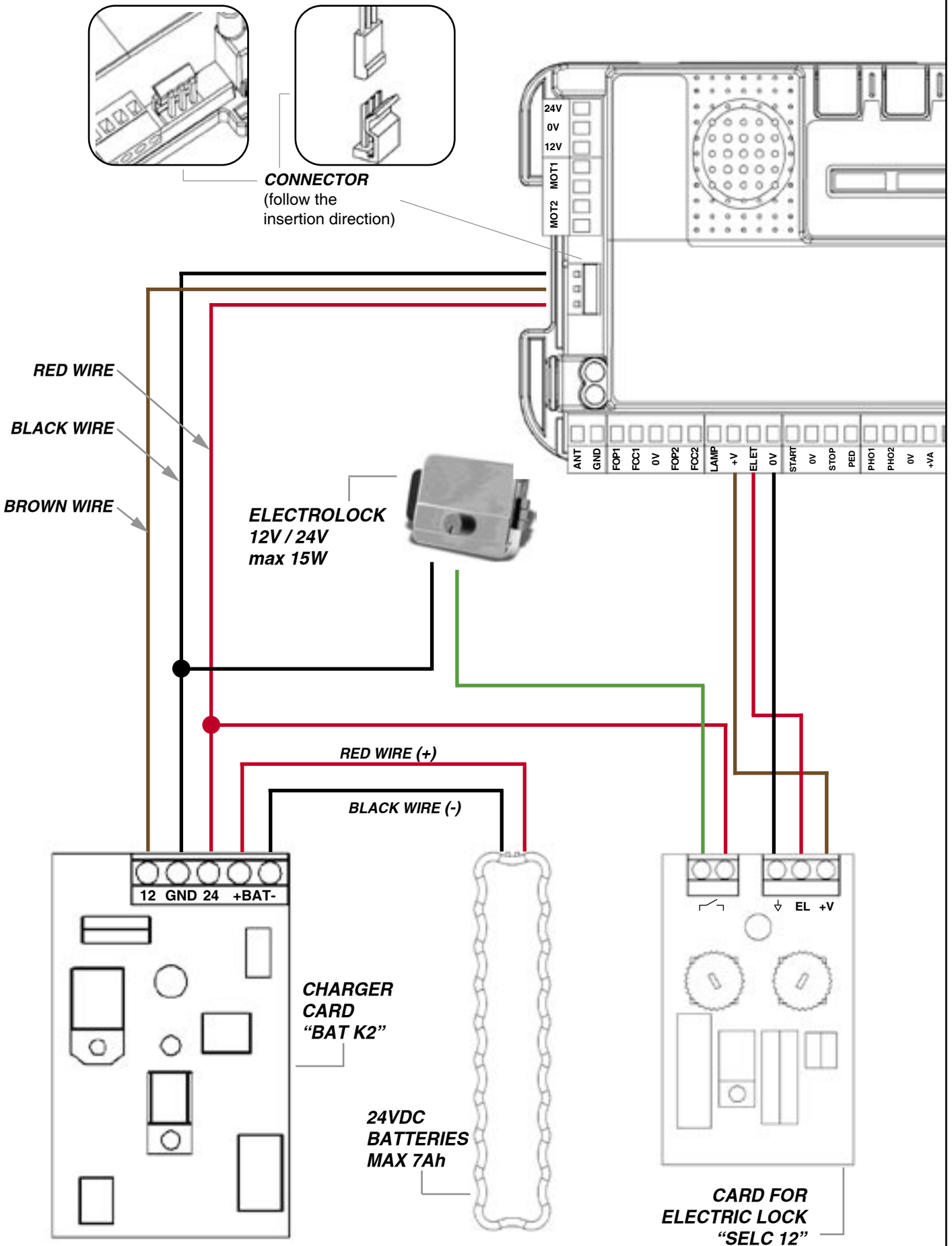

6 - CONNECTION OF AN ELECTRO LOCK WITH "SELC 100"

In presence of an electro lock (manageable only by the control units "Star 224" and "Star M224") connect it as shown below.

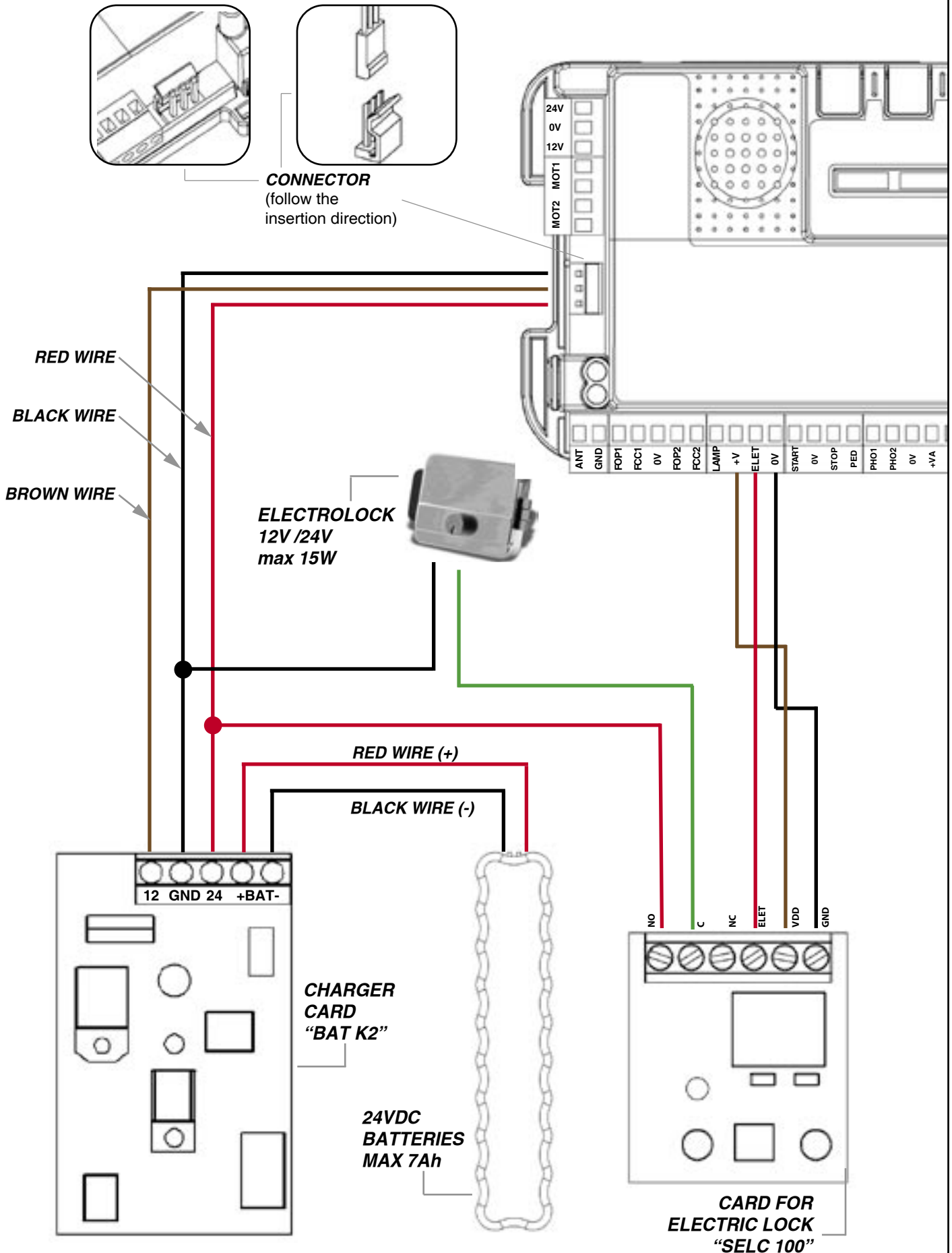



KING gates - Brand of Antonioli Mario & C. s a s
Via A. Malignani, 42 - 33077 Sacile (PN) ITALY Tel. +39 0434 737082 - Fax +39 0434 783382
e-mail: info@king-gates.com web: www.king-gates.com