

ENGLISH

Instructions manual

SAPE 69

Proximity card access control



*Item 690
Card reader
partial recess*



*Item 691
Card reader
surface*



*Item 692
Receiver*

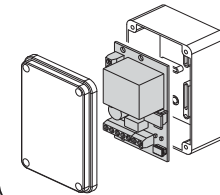

*Item 693
Installation
cards*



*Item 694
Control
card*



*Item 695
Control
keyring*



*Item 696
Special reader
partial recess*



*Management
Software
for PC*



GB



Direttiva 2002/96/CE
Smaltimento dei materiali
elettrici ed elettronici
VIETATO GETTARE NEI RIFIUTI
MATERIALI NOCIVI PER L'AMBIENTE



FADINI
l'apricancello
made in Italy

BRINGING THE CARD READER APART

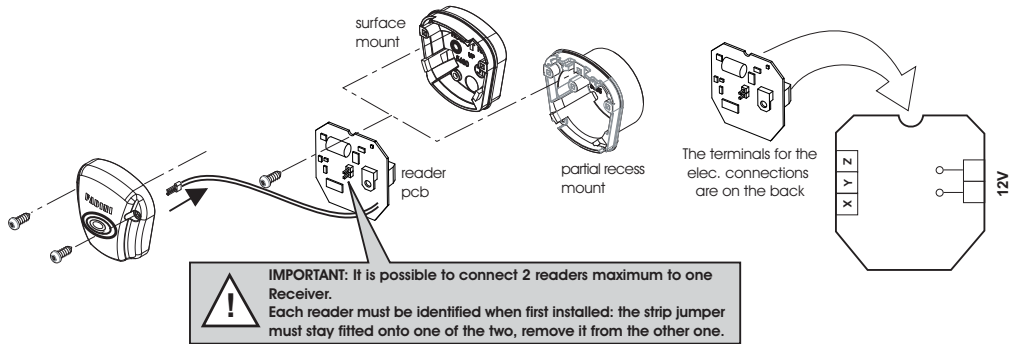

Pic.1

FITTING ACCESSORIES FOR THE PARTIALLY RECESSED APPLICATION

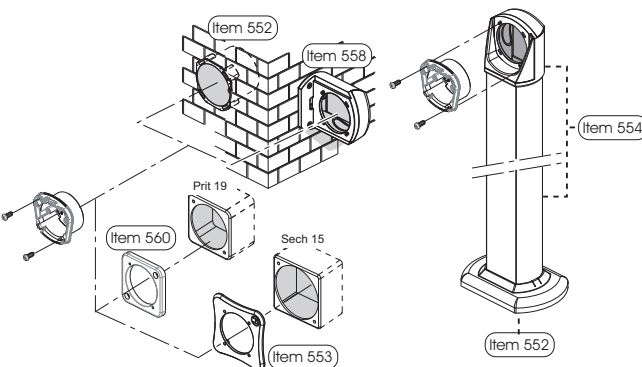

Pic.2

SURFACE APPLICATION

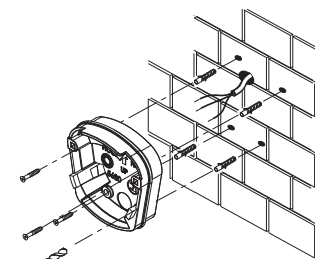

Pic.3

PROGRAMMING AND READING CARDS

- GREEN (*) card:** to memorize the Blue cards and the keyrings
- RED (*) card:** to memorize the Blue cards and the keyrings
- BLUE card or keyring:** for the end user to open and close the access



(*) Cards to be used by the installation technician.

The two cards (Red and Green), at the time when the equipment is first installed, are both memorized into the Removable memory. Blanking or replacing them can only be carried out by the manufacturer Meccanica Fadini after returning the removable memory. Should a duplicate of the two cards (Red and Green) be required, the number printed on the back is to be provided.

The cards or the keyrings are actually read on touching the reader; confirmation of the reading is indicated by the illumination of a **Blue Led** and by a beep sound from the receiver.

Pic.4

GENERAL DESCRIPTION

The proximity card reader **SAPE 69** is a control accessory designed to open and close any automated access. **SAPE 69** consists of a **reader**, operated by magnetic cards or keyrings, and cable connected to the respective **Receiver**. The Receiver is fitted with a removable memory, where the Blue cards or the keyrings and the installation Red and Green cards are memorized (during the first installation and cannot be cancelled or replaced unless returned to the manufacturer). In the memory there are two independent lists where the users' cards can be memorized: each list can take up to 2,000 users' cards. The memorizing operations of the individual Blue cards or keyrings are through Dip-switch 1 or Dip-switch 2 set to ON. Cancelling is by Dip-switch 1 or 2 set to ON along with Dip-switch 3 to ON. The Receiver elaborates the memorizing process of the cards and keyrings in the memory and confirms the operation by giving out a sound, while a green led switches on. Cards or keyrings, that are not memorized in the lists, are indicated by a prolonged acoustic signal. The reader allows only for the cards and keyrings to be read, which is confirmed by the blue led switching on. The installation of SAPE 69 is completed after going through the programming phases: to make this process easier and quick, two types of cards are available, **Red** and **Green**. They allow to memorize and cancel the end users' Blue cards and the keyrings, if required. The receiver is 230V 50Hz power supplied and provides a 12V output to power the readers, a relay output, a clean NO contact for remote switching applications if needed, and three inputs X - Y - Z to communicate with the readers ("Z" to be used only in the case when the communication signal between reader - receiver is weak or disturbed). It is possible to complete the equipment with a software to manage the entire system at a distance. In this way, an electronic data base can be created to easily operate with SAPE 69 through a PC.

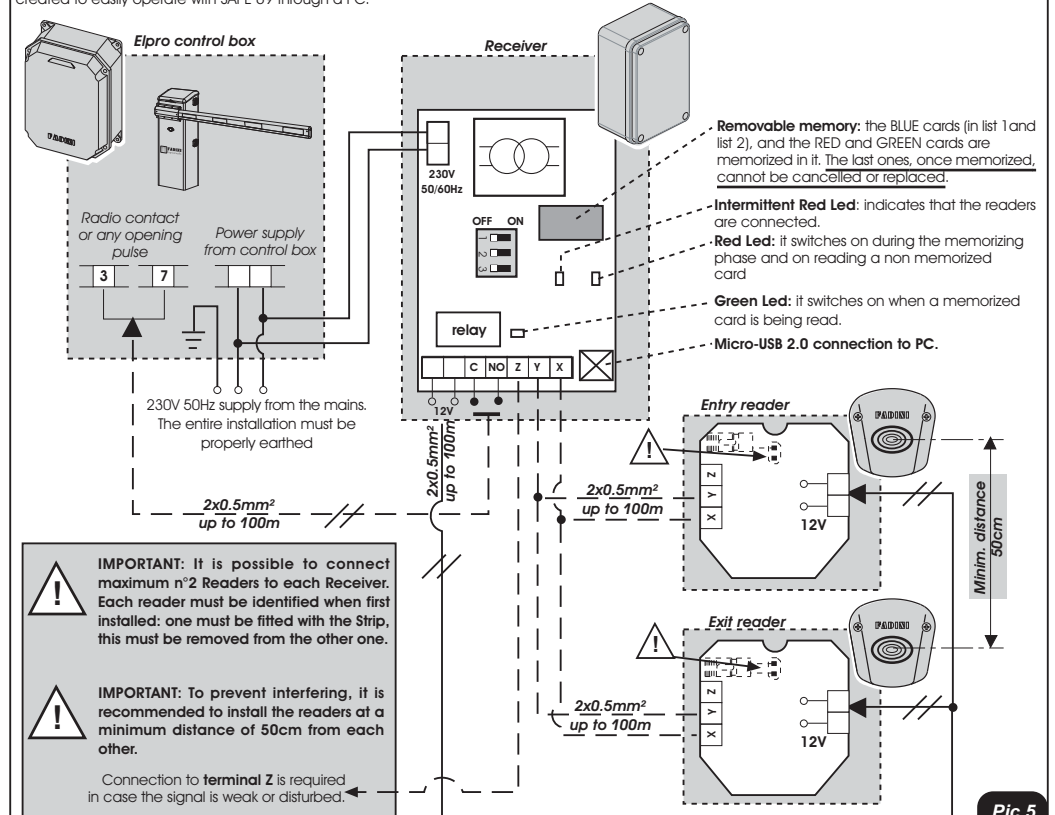

Pic.5

DIP-SWITCHES

The removable memory is designed to include 2 lists, each one can take up to 1,000 possible cards. The two lists can be accessed and controlled by Dip-Switches 1, 2 and 3.

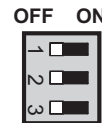

- Dip1 = ON** allows access to List 1 to carry on card memorizing and cancelling.
- Dip2 = ON** allows access to list 2 to carry on card memorizing and cancelling
- Dip3 = ON** the entire memory is blanked by the RED card. Combined to DIP-switch 1 or 2 set to ON, only the selected one list is blanked.

Pic.6

ACOUSTIC SIGNAL

The acoustic signal helps with the memorizing and reading phases of the cards or keyrings. This device is fitted in the receiver.

- Long Beep** = A card not memorized in the list is being read. When the memory is being blanked, a sound is given out for 30 seconds.
- Single Beep** = a new card is being memorized or a listed card is being read.
- Alternated fast Beeps** = memorizing phase (by the Green card), or blanking phase (by the Red card).

Pic.7

MEMORIZING THE BLUE CARDS OR THE KEYRINGS

Important: when the equipment is first installed, and the Green card is read and therefore memorized into the system, the Red card is automatically memorized, too. Both cannot be cancelled or replaced, only the manufacturer can do this. In this way the installation is uniquely controlled by the possessor of the Green and Red cards.

- 1) Set to **ON** either **DIP-sw. 1** or **DIP-sw. 2** (only one of the two): Dip-sw. 1 to access list 1 (faster in reading than list 2), and Dip-sw. 2 to access list 2.
- 2) Bring the **GREEN card to touch one reader** (in case of two readers, this operation can be carried on only with one of them). The red led in the receiver starts flashing and a fast, alternate acoustic signal can be heard, indicating that the memorizing process is on.
- 3) Bring, one by one, the **BLUE cards or the keyrings** to touch the reader to have them memorized (the Blue led on the Reader switches on whenever a card or a keyring is read; wait until it is off again before doing the same with other units).
- 4) Bring again the **GREEN card** to touch the reader once card/keyring memorizing is over. Should new cards/keyrings be required to be entered, wait 3 seconds and bring again the Green card to touch the reader.

Diagram

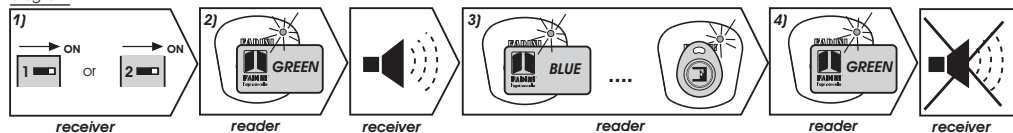

NOTE: Once memorizing is completed, unless the GREEN card is brought to touch the reader in 1 minute's time, the procedure is closed, but the cards/keyrings are retained in the memory. If the RED card is used by mistake, the procedure is interrupted.

Pic.8

INDIVIDUAL BLUE CARDS OR KEYRINGS CANCELLING

Should any card or keyring be lost, removal from the system can be done only through the software by a PC (it is understood that the names of the users/customers must be available in that they were previously memorized in the list), as an alternative the entire list is to be cancelled and the cards memorized again.

- 1) Set to **ON** either **DIP 1** or **DIP 2** (only one of the two): Dip 1 to access list 1, Dip 2 to access list 2.
- 2) Bring the **RED card to touch one reader** (in case of two readers, this operation can be carried on only with one of them). The red led in the receiver starts flashing and a fast, alternate acoustic signal can be heard, indicating that the cancelling process is on.
- 3) Bring, one by one, the **BLUE cards or the keyrings** to touch the reader to cancell them from the pre-selected list (the Blue led on the Reader switches on whenever a card or a keyring is read; wait until it is off again before doing the same with other units).
- 4) Bring again the **RED card** to touch the reader once card/keyring cancelling is over. Should new cards/keyrings be required to be cancelled, wait 3 seconds and bring again the Red card to touch the reader.

Diagram

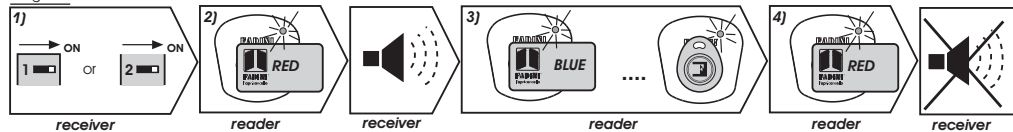

NOTE: Once cancelling is completed, unless the RED card touches the reader in 1 minute's time, the procedure is closed, anyway the previously cancelled cards/keyrings are no longer in the memory. If the GREEN card is brought to touch the reader by mistake, the procedure is interrupted.

Pic.9

TOTAL REMOVAL OF LIST 1 OR LIST 2

- 1) Set to **ON** the **DIP** corresponding to the list required to be removed: Dip 1 for list1, and Dip 2 for list 2. Set to **ON even DIP 3**.
- 2) Bring the **RED card to touch one reader** (in case of 2 readers, this operation can be carried on only with one of them). The red led in the receiver goes on and a sound can be heard for 30 seconds. During this time the entire selected list is deleted. But the two installer's cards, RED and GREEN, are not disabled.
- 3) Once the 30 seconds are over, the memory is blanked.
- 4) On the red led going off and the sound stopping, set all of the dip-switches to OFF.

Diagram

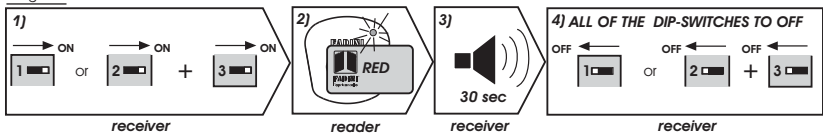

Pic.10

SOFTWARE SAPE 69 FOR PC MANAGEMENT

General description

The SAPE 69 system, previously described as a simple electronic system operated through cards or keyrings, can be integrated with a software allowing the user to create a data base of the entire installation.

The software allows the management of the two users' lists, once the user's cards and keyrings have been entered: it is possible to identify each single card/keyring by including the end user's data (name and address), enable/disable each single card/keyring, remove any single card/keyring from the lists and specify the period of use of any card/keyring by indicating an expiry date.

Important: memorizing the cards/keyrings is only by means of the GREEN card, whereas cancelling is made possible only by means of the RED card or by PC.

SAPE 69 system: simple installation without the help of the software (see Pic.6 for the electrical connections)

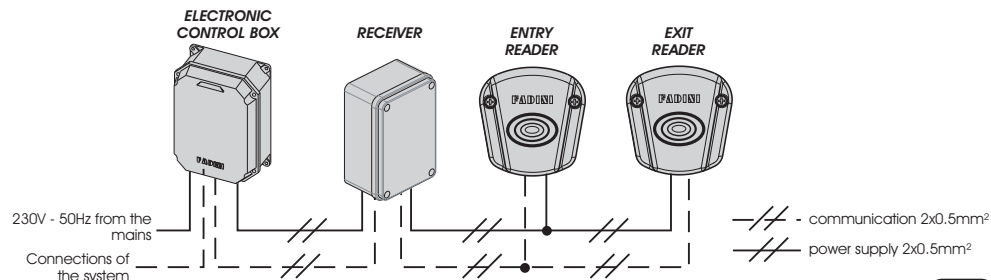

Pic.11

To facilitate the agent with the customer management by the PC, a special reader is combined to the software: once the special reader has been connected to the receiver, it is possible to operate with the cards/keyrings avoiding that the gate/door is opened/closed during the management (this reader is distinguished by the colour of the electronic pcb being white).

Software for the management of the SAPE 69 system

Note: to make the software easier to be installed and managed, it is advisable that the Receiver be installed near to PC.

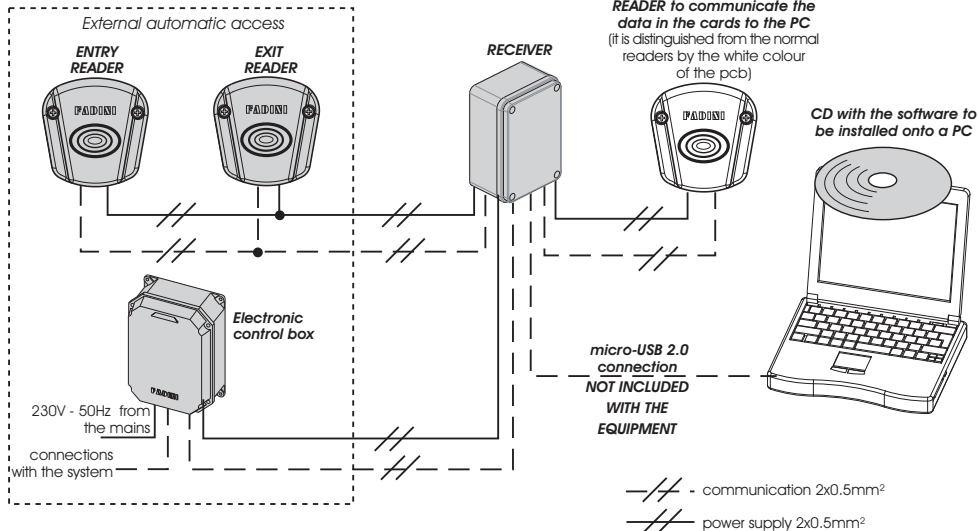

Pic.12

SOFTWARE INSTALLATION

- Open the folder and select automatic installation of the software.
- Once the electrical connections are completed as detailed in Pic.6 and Pic.13, select the icon and run the program.



Pic.13

IMPORTANT: All of the data included in the cards/keyings are stored in the removable memory of the Receiver; before changing or updating the data in the lists stored in the memory, it is required that the data (in list 1 and list 2) are made available in the PC by clicking "READ CARD LIST". After changing/updating the user's data, it is required to update the receiver memory by clicking "WRITE CARD LIST".

ACQUIRING THE DATA FROM THE RECEIVER MEMORY:

After opening the software, it is necessary to acquire the data from the receiver Memory by clicking "READ CARD LIST" and wait until the operation is finished. Second step, the data are to be saved as; and an error window appears (to be ignored).

IMPORTANT: whenever the software is run and in order to update the data in the memory (once a day at least, preferably on starting the system), it is recommended to acquire the data from the receiver memory (READ CARD LIST) and then update it (WRITE CARD LIST).

NAMING AND CUSTOMIZING THE CARDS/KEYINGS:

In the case where users' cards/keyings have already been stored into the system, the window of the provided software shows all the available data. In the case where the installation is new and no data have been stored yet in the two lists, it is required to "load the memory" with the available data (by means of the GREEN card, standard procedure as on page 11) and then pass them on to the PC through the "Communication reader".

Select the previously stored user's card/keying in the column "CUSTOMER DATA". Click "MODIFY" to be allowed to enter the following sections and change the data as required:

- "FIRST NAME", "LAST NAME", "ADDRESS", "NOTES": enter the available information to customize the selected card/keying.
- "ENABLE": if the box is "ticked", the card/keying is enabled for access operations. If a new card/keying is required to be enabled, "tick" the box and, once the new entry is saved, click "WRITE CARD LIST" to send the information to the receiver memory. **Note:** The box in the column "DISABLED" shows "X" if the respective card/keying is disabled.
- "LIST": when the card/keying is being read, it is indicated in which list it is stored. In the case of a new card/keying it is possible to indicate in which list it can be saved by "ticking" "1" or "2" and clicking "WRITE CARD LIST".
- "CARD CODE": when a card/keying is being read, an identification internal code is visualized.
- "EXPIRY DATE": It is possible to set a date of expiry to the period of time a card/keying can be used by its possessor. Important: once a day at least click "WRITE CARD LIST" to update the dates in the memory (recommended on starting the system, or every day in the early morning).
- "CANCEL": it is possible to individually cancel the cards/keyings from the memory by clicking "CANCEL", without moving the Dip-switches in the receiver; N.W. The cards/ keyings are loaded into the memory always and exclusively by the GREEN card (page 11).
- "SEARCH": it is possible to search a card/keying in the created data base either by the NAME OF THE CUSTOMER or by the CODE number.

EXPORTING THE DATA BASE TO A FILE:

It is possible to export the file you are working with and containing the entire list of the cards/keyings in the memory by clicking "EXPORT CARD LIST". A .txt file is thus created having the same name, in the same folder. It will be then possible to print it in a personalized format through other programs (eg. excel).

OVERALL DIMENSIONS

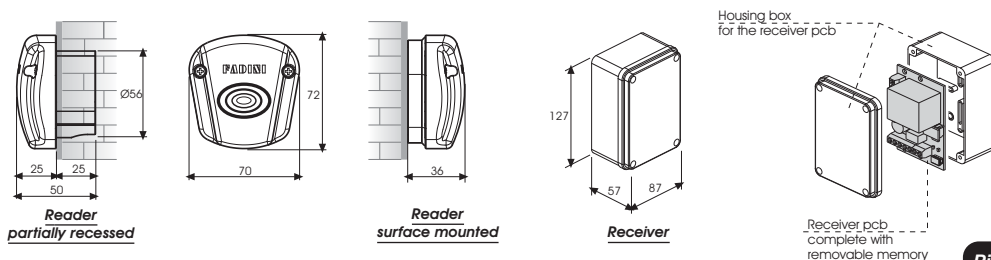

Pic.14

TECHNICAL DATA

- Receiver voltage supply 230Vac ±10% - 50Hz
- Reader supply (from the receiver) .. 12V
- Reader max. absorption, each .. 50 mA
- Receiver max. absorption 10 mA
- Working temperature -20° +80°C
- NO output channels 1
- Communication distance max 100 m
- Output contacts 1A - 125V - 60VA
- Reader protection standards IP 56
- Receiver protection standards IP 65
- Memory List 1 2000 cards
- Memory List 2 2000 cards

The manufacturer reserves the right to change this manual without notice, and is not liable for incorrect applications and damages to persons and properties.

DECLARATION OF CONFORMITY of the Manufacturer



Via Mantova 177/A - C.P. 126 - 37053 Cerea (VR) Italy
Tel. +39 0442 330422 - Fax +39 0442 331054
e-mail: info@fadini.net - www.fadini.net

Manufacturing company: meccanica **FADINI**

DECLARES UNDER ITS OWN RESPONSIBILITY THAT:

SAPE 69

Model: SAPE 69

Sape 69 is an access control proximity system and is designed and sold to be incorporated into an "automatic gate system", including original accessories and components as recommended by the Manufacturing Company. The installer must issue a Declaration of Compliance and carry out all the tests as required to comply with the existing safety regulations.

The Manufacturing Company is not liable for any incorrect application of the product. The product complies with the following applicable norms:

- Low Voltage Directive 2006/95 CE
- Electro-magnetic Compatibility Directive 2004/108/CE and 92/31 CEE



Date: 20 - 04 - 11

meccanica **FADINI** s.n.c.

The Responsible Manager

